

- ① OFURO BATHTUB
- ② SHOWER
- ③ TOILET
- ④ VANITY
- ⑤ KITCHENETTE
- ⑥ BED WITH SIDEBOARDS
- ⑦ DINING TABLE
- ⑧ FIRE AND ENTERTAINMENT UNIT
- ⑨ COUCH AND COFFEE TABLE
- ⑩ WEST DECK
- ⑪ NORTH DECK



CONCEPT PLAN A
scale 1:100

QUICK LIVING
MODULAR HOUSING

Module Creative Limited REAR UNIT, 1027 FERRY ROAD, FERRYMEAD, CHRISTCHURCH
PHONE (03) 384 9474 FAX- (03) 384 8317 EMAIL - info@quickliving.co.nz WEB - www.quickliving.co.nz

Scale: 1:100	DATE: 26/08/08	CONCEPT FLOOR PLAN A.01	ACCOMMODATION UNITS PORTS HILLS, CHCH, NZ
<small>THIS DRAWING AND ALL ASSOCIATED SPECIFICATIONS / INSTRUCTIONS REMAIN INTELLECTUAL PROPERTY OF MODULE CREATIVE LIMITED</small>			

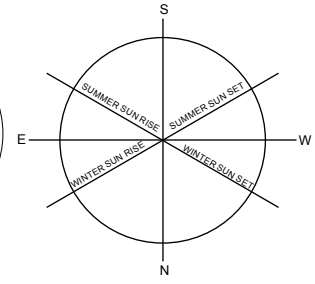
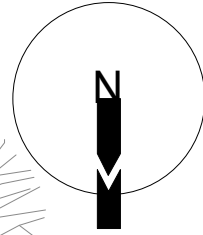
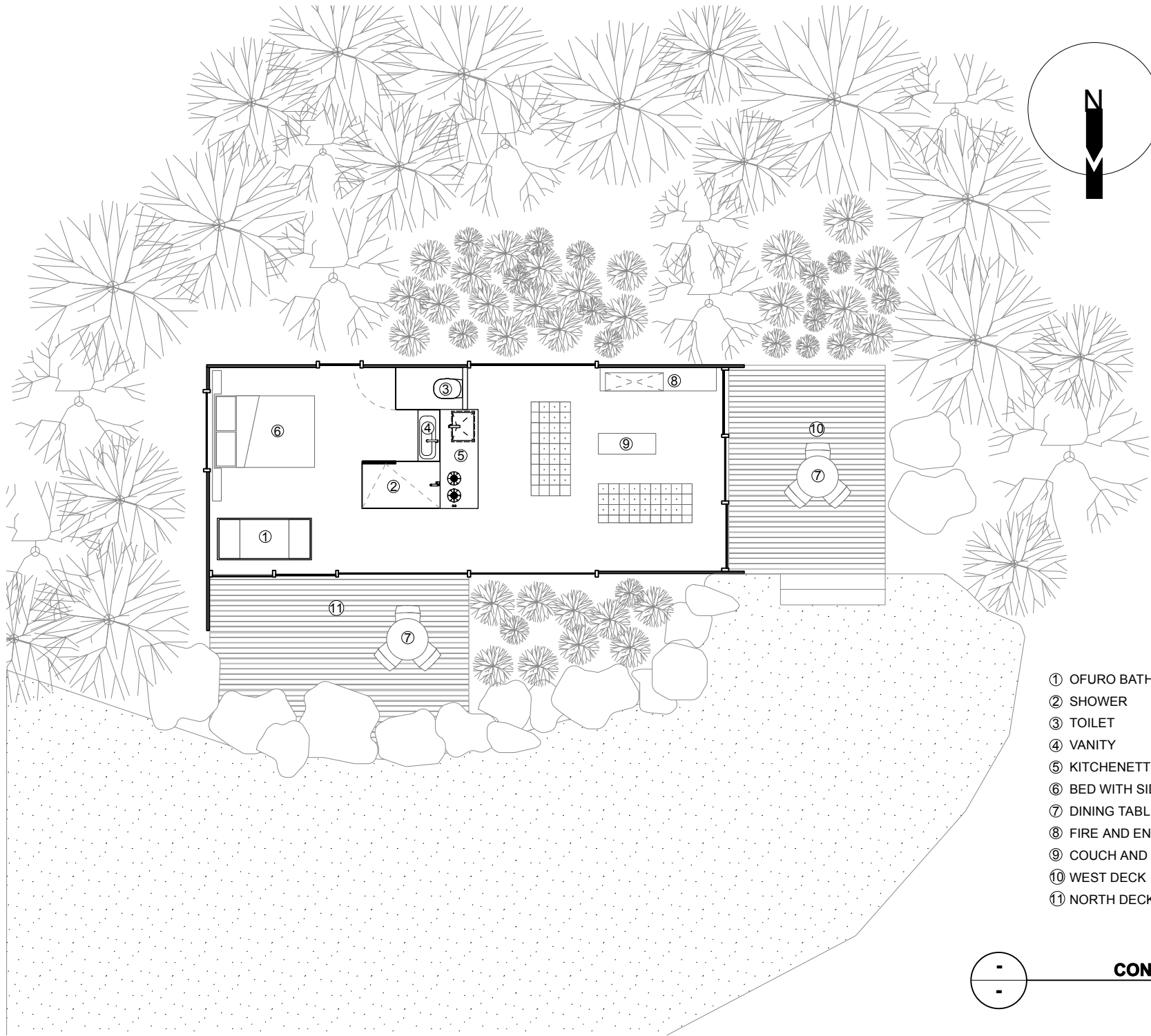

- ① OFURO BATHTUB
- ② SHOWER
- ③ TOILET
- ④ VANITY
- ⑤ KITCHENETTE
- ⑥ BED WITH SIDEBOARDS
- ⑦ DINING TABLE
- ⑧ FIRE AND ENTERTAINMENT UNIT
- ⑨ COUCH AND COFFEE TABLE
- ⑩ WEST DECK
- ⑪ NORTH DECK

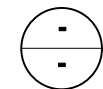

CONCEPT PLAN B
scale 1:100



Scale: 1:100 Date: 26/08/08 Drawing No:	CONCEPT FLOOR PLAN	ACCOMADATION UNITS PORTS HILLS, CHCH, NZ
A.02		
THIS DRAWING AND ALL ASSOCIATED SPECIFICATIONS / INSTRUCTIONS REMAIN INTELLECTUAL PROPERTY OF MODULE CREATIVE LIMITED		

Module Creative Limited REAR UNIT, 1027 FERRY ROAD, FERRYMEAD, CHRISTCHURCH
PHONE (03) 384 9474 FAX- (03) 384 8317 EMAIL - info@quickliving.co.nz WEB - www.quickliving.co.nz

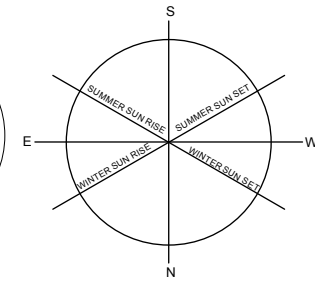
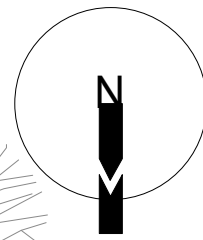
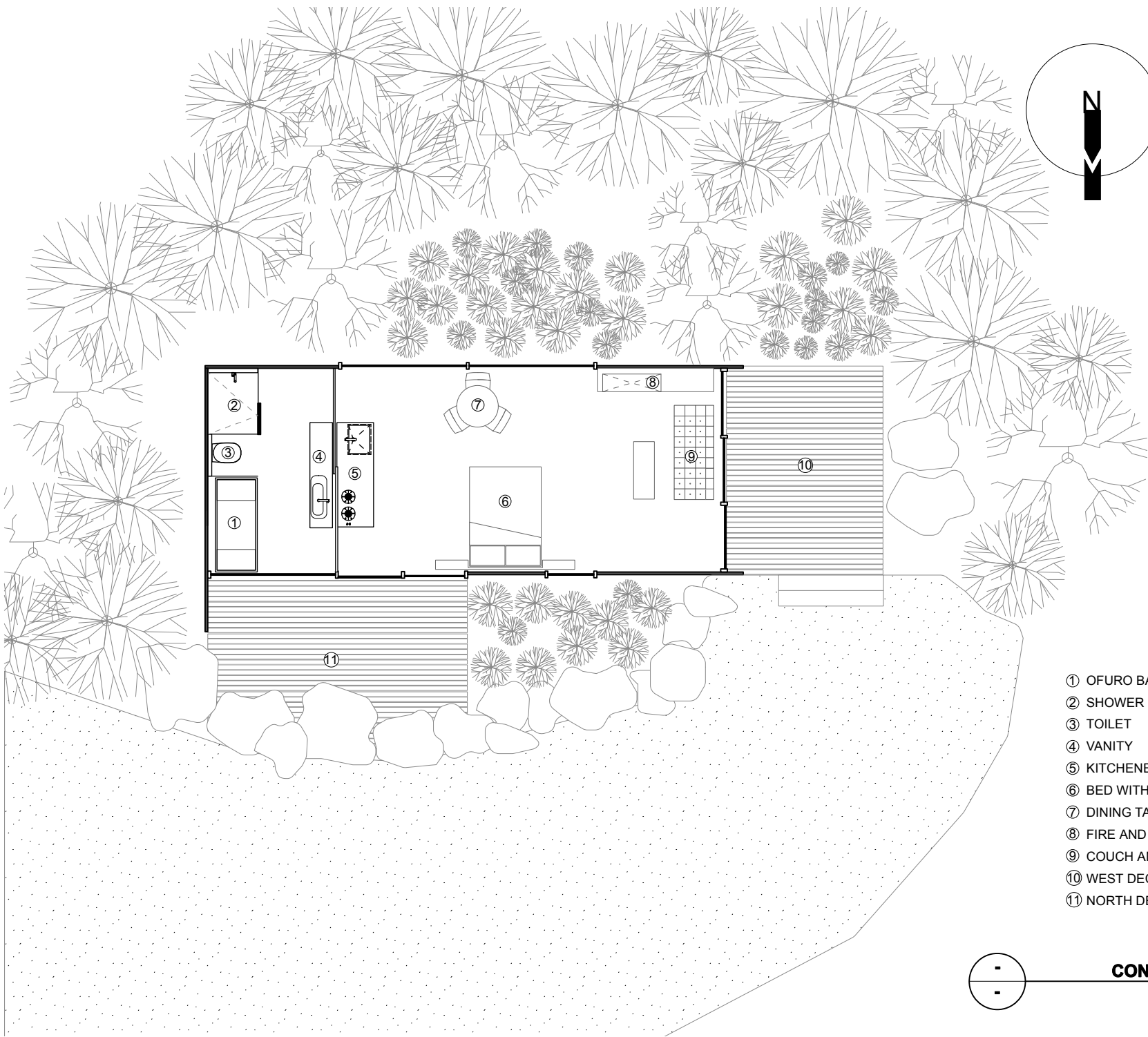

- ① OFURO BATHTUB
- ② SHOWER
- ③ TOILET
- ④ VANITY
- ⑤ KITCHENETTE
- ⑥ BED WITH SIDEBOARDS
- ⑦ DINING TABLE
- ⑧ FIRE AND ENTERTAINMENT UNIT
- ⑨ COUCH AND COFFEE TABLE
- ⑩ WEST DECK
- ⑪ NORTH DECK

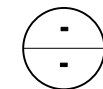

CONCEPT PLAN C
scale 1:100



Scale: 1:100	Project: ACCOMADATION UNITS PORTS HILLS, CHCH, NZ
Date: 26/08/08	Project: CONCEPT FLOOR PLAN
Drawn by: A.03	Project: ACCOMADATION UNITS PORTS HILLS, CHCH, NZ

Module Creative Limited REAR UNIT, 1027 FERRY ROAD, FERRYMEAD, CHRISTCHURCH
 PHONE (03) 384 9474 FAX- (03) 384 8317 EMAIL - info@quickliving.co.nz WEB - www.quickliving.co.nz

THIS DRAWING AND ALL ASSOCIATED SPECIFICATIONS / INSTRUCTIONS REMAIN INTELLECTUAL PROPERTY OF MODULE CREATIVE LIMITED

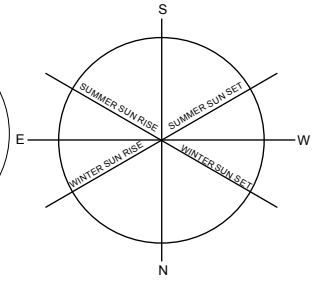
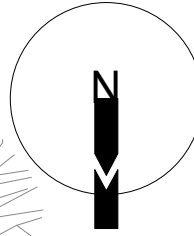
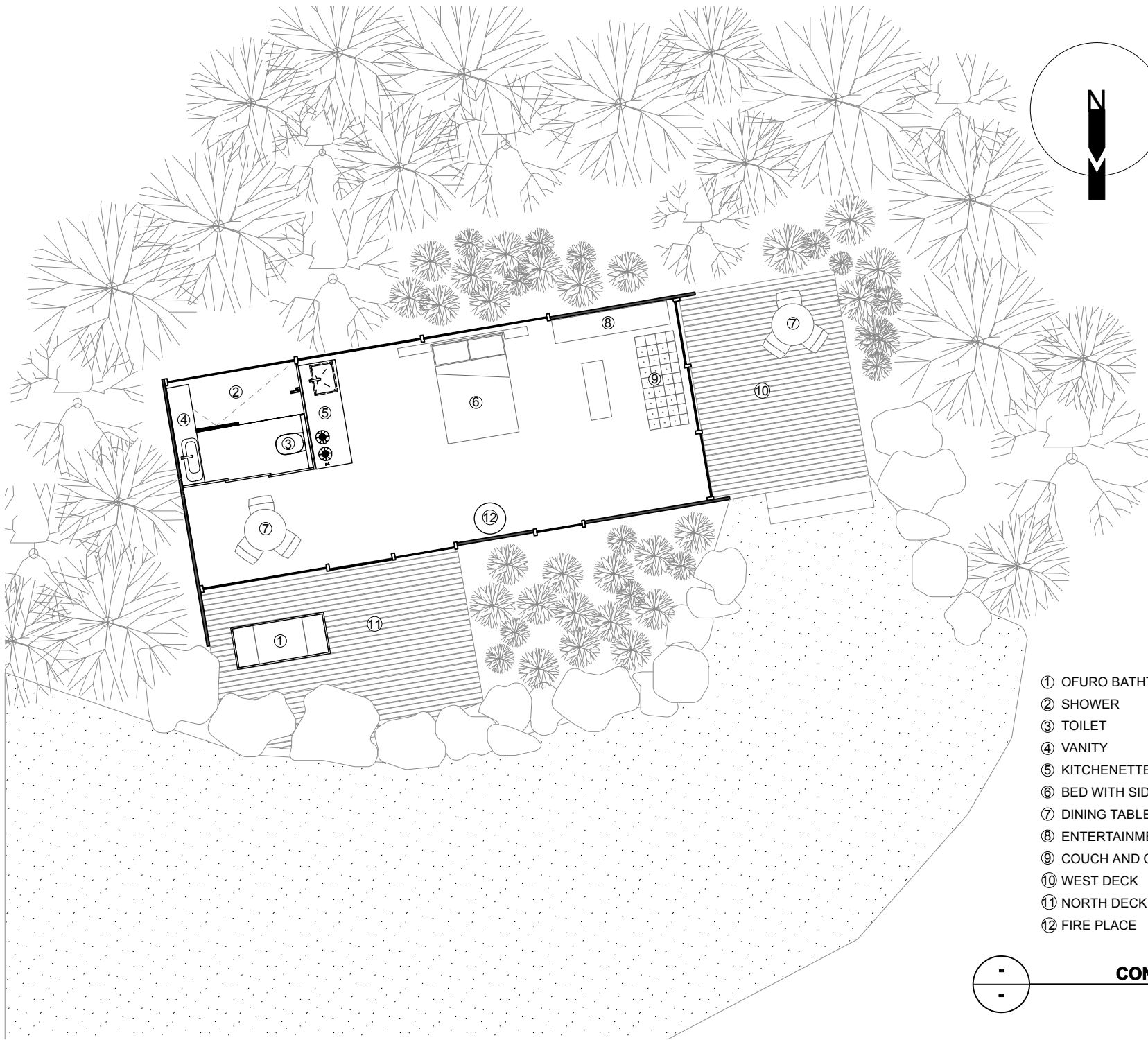

- ① OFURO BATHTUB
- ② SHOWER
- ③ TOILET
- ④ VANITY
- ⑤ KITCHENETTE
- ⑥ BED WITH SIDEBARDS
- ⑦ DINING TABLE
- ⑧ ENTERTAINMENT UNIT
- ⑨ COUCH AND COFFEE TABLE
- ⑩ WEST DECK
- ⑪ NORTH DECK
- ⑫ FIRE PLACE



CONCEPT PLAN D
scale 1:100



<small>Scale</small> 1:100 <small>Issue Date</small> 26/08/08 <small>Drawing No.</small> A.04	<small>Project Name</small> CONCEPT FLOOR PLAN	<small>Product Name</small> ACCOMMODATION UNITS PORTS HILLS, CHCH, NZ
---	--	---

Module Creative Limited REAR UNIT, 1027 FERRY ROAD, FERRYMEAD, CHRISTCHURCH
PHONE (03) 384 9474 FAX- (03) 384 8317 EMAIL - info@quickliving.co.nz WEB - www.quickliving.co.nz

THIS DRAWING AND ALL ASSOCIATED SPECIFICATIONS / INSTRUCTIONS REMAIN INTELLECTUAL PROPERTY OF MODULE CREATIVE LIMITED

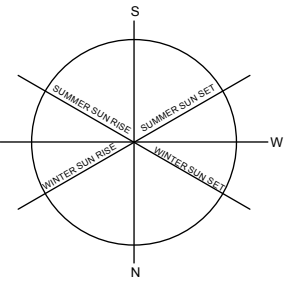
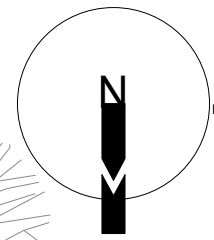
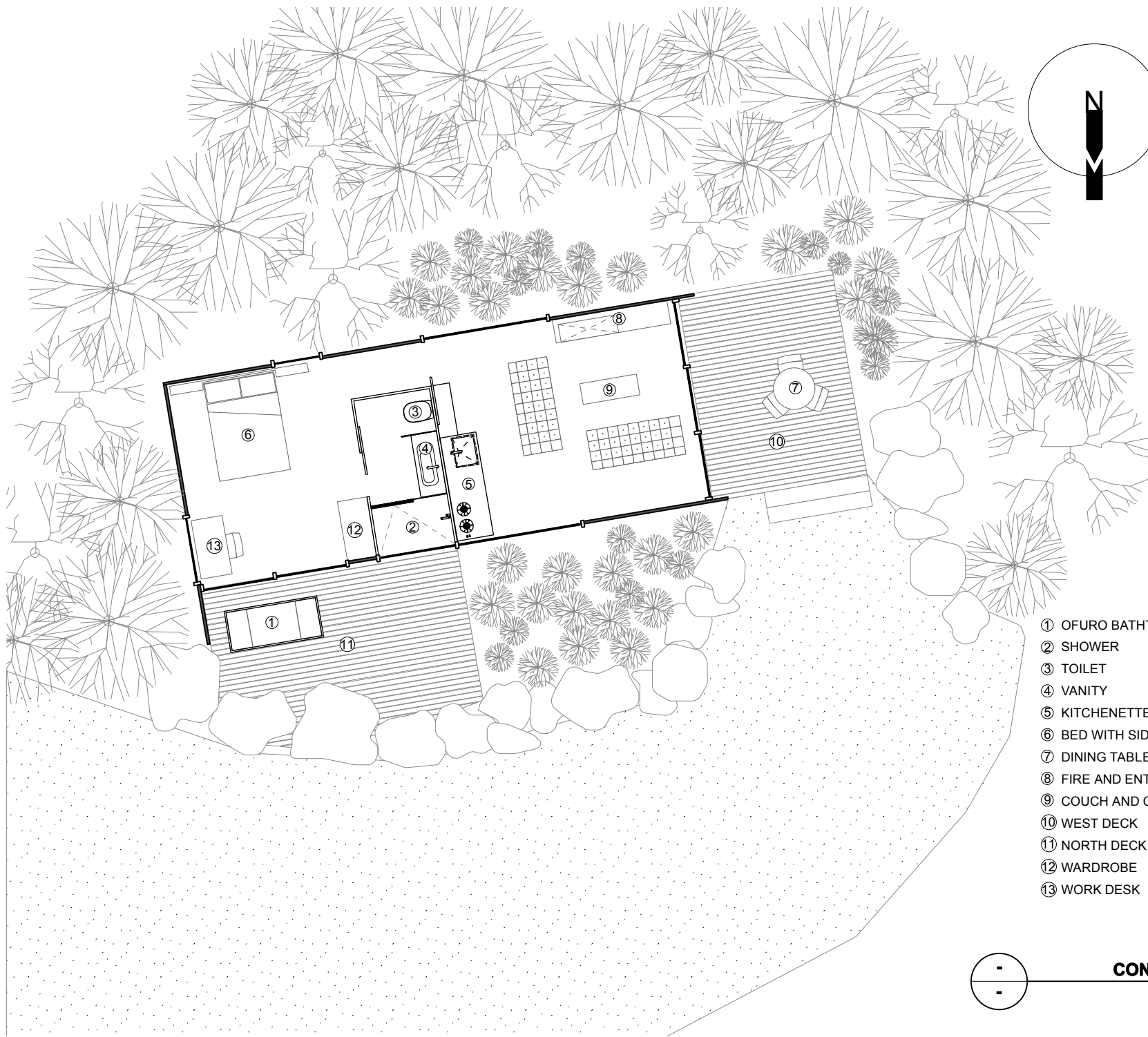

- ① OFURO BATHTUB
- ② SHOWER
- ③ TOILET
- ④ VANITY
- ⑤ KITCHENETTE
- ⑥ BED WITH SIDEBARDS
- ⑦ DINING TABLE
- ⑧ FIRE AND ENTERTAINMENT UNIT
- ⑨ COUCH AND COFFEE TABLE
- ⑩ WEST DECK
- ⑪ NORTH DECK
- ⑫ WARDROBE
- ⑬ WORK DESK



CONCEPT PLAN E
scale 1:100



SCALE 1:100	DATE 26/08/08	PROJECT ACCOMMODATION UNITS PORTS HILLS, CHCH, NZ	DRAWING NO. A.05
----------------	------------------	---	----------------------------

Module Creative Limited REAR UNIT, 1027 FERRY ROAD, FERRYMEAD, CHRISTCHURCH
PHONE (03) 384 9474 FAX- (03) 384 8317 EMAIL - info@quickliving.co.nz WEB - www.quickliving.co.nz

THIS DRAWING AND ALL ASSOCIATED SPECIFICATIONS / INSTRUCTIONS
REMAIN INTELLECTUAL PROPERTY OF MODULE CREATIVE LIMITED

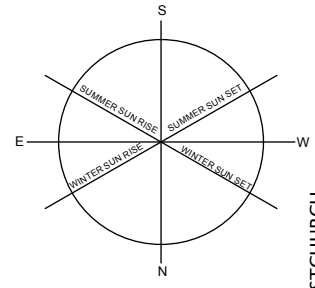
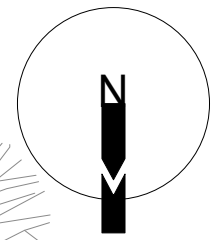
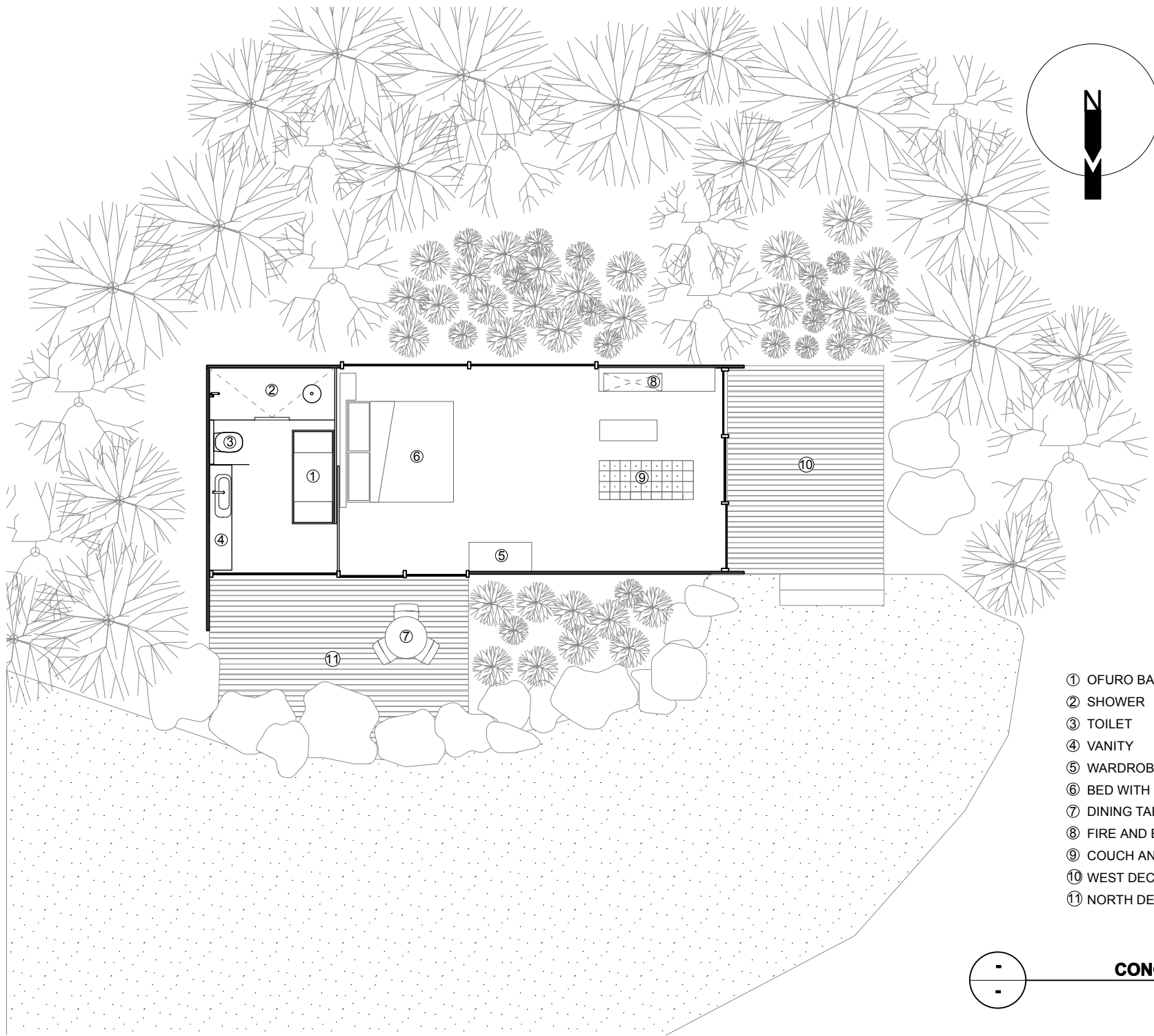

- ① OFURO BATHTUB
- ② SHOWER
- ③ TOILET
- ④ VANITY
- ⑤ WARDROBE
- ⑥ BED WITH SIDEBOARDS
- ⑦ DINING TABLE
- ⑧ FIRE AND ENTERTAINMENT UNIT
- ⑨ COUCH AND COFFEE TABLE
- ⑩ WEST DECK
- ⑪ NORTH DECK

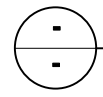

CONCEPT PLAN F
scale 1:100



Scale: 1:100	Project: ACCOMMODATION UNITS PORTS HILLS, CHCH, NZ
Date: 26/08/08	Rev: 01
Project Name: RESOLVED CONCEPT FLOOR PLAN	Project No: A.06

Module Creative Limited REAR UNIT, 1027 FERRY ROAD, FERRYMEAD, CHRISTCHURCH
 PHONE (03) 384 9474 FAX- (03) 384 8317 EMAIL - info@quickliving.co.nz WEB - www.quickliving.co.nz

THIS DRAWING AND ALL ASSOCIATED SPECIFICATIONS / INSTRUCTIONS REMAIN INTELLECTUAL PROPERTY OF MODULE CREATIVE LIMITED

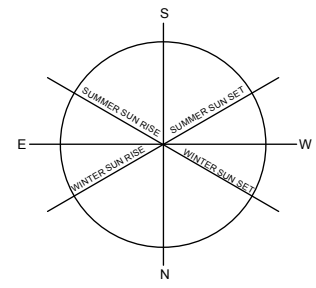
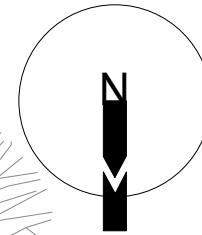
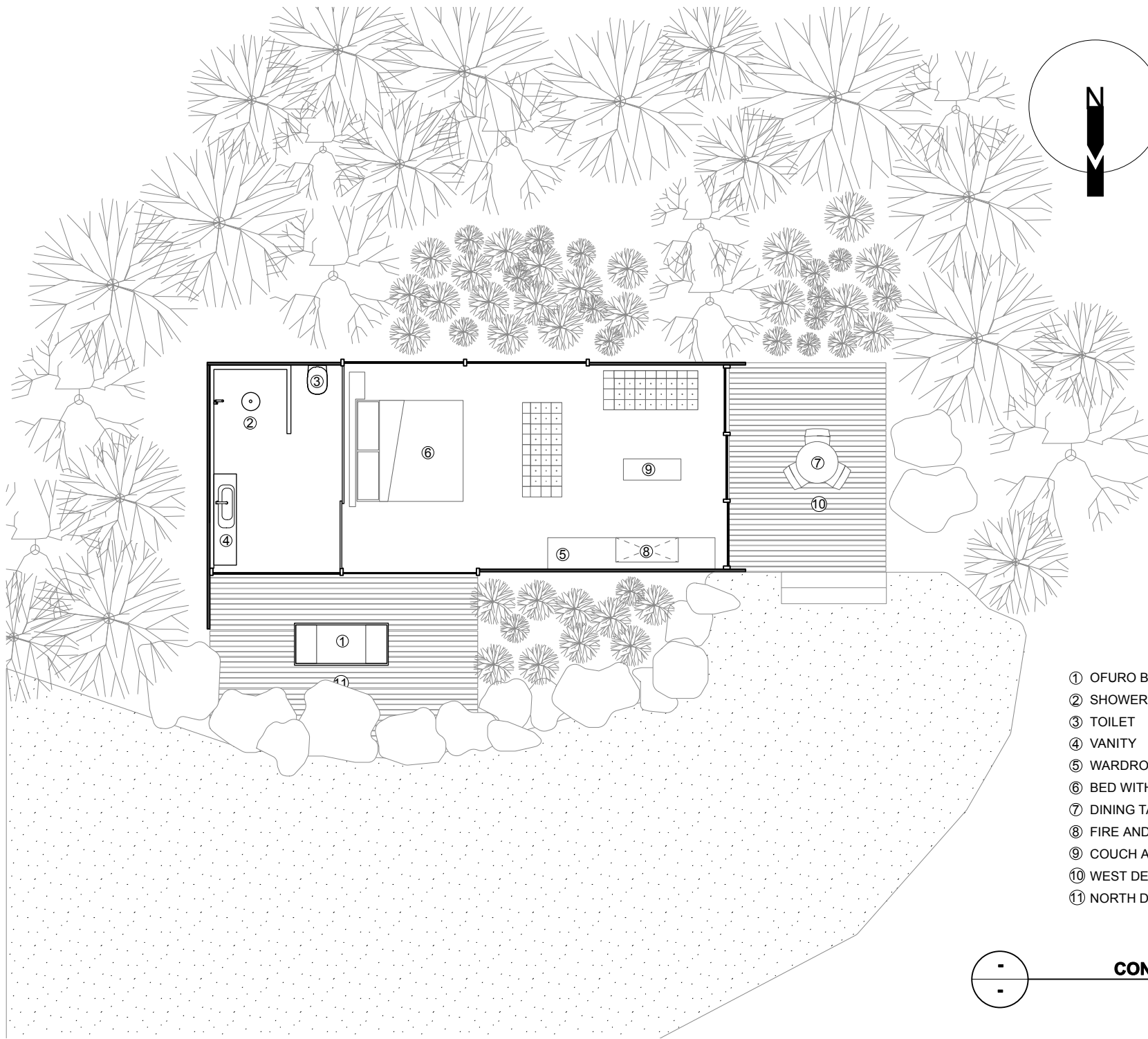

- ① OFURO BATHTUB
- ② SHOWER
- ③ TOILET
- ④ VANITY
- ⑤ WARDROBE
- ⑥ BED WITH SIDEBOARDS
- ⑦ DINING TABLE
- ⑧ FIRE AND ENTERTAINMENT UNIT
- ⑨ COUCH AND COFFEE TABLE
- ⑩ WEST DECK
- ⑪ NORTH DECK

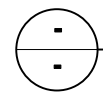

CONCEPT PLAN G
scale 1:100



Scale: 1:100	Project: RESOLVED CONCEPT FLOOR PLAN	Product: ACCOMADATION UNITS PORTS HILLS, CHCH, NZ
Date: 26/08/08		
Drawing No: A.07		

Module Creative Limited REAR UNIT, 1027 FERRY ROAD, FERRYMEAD, CHRISTCHURCH
 PHONE (03) 384 9474 FAX- (03) 384 8317 EMAIL - info@quickliving.co.nz WEB - www.quickliving.co.nz

THIS DRAWING AND ALL ASSOCIATED SPECIFICATIONS / INSTRUCTIONS REMAIN INTELLECTUAL PROPERTY OF MODULE CREATIVE LIMITED

QUICK LIVING

MODULAR HOUSING

Imagine building your home in 30 days... we can

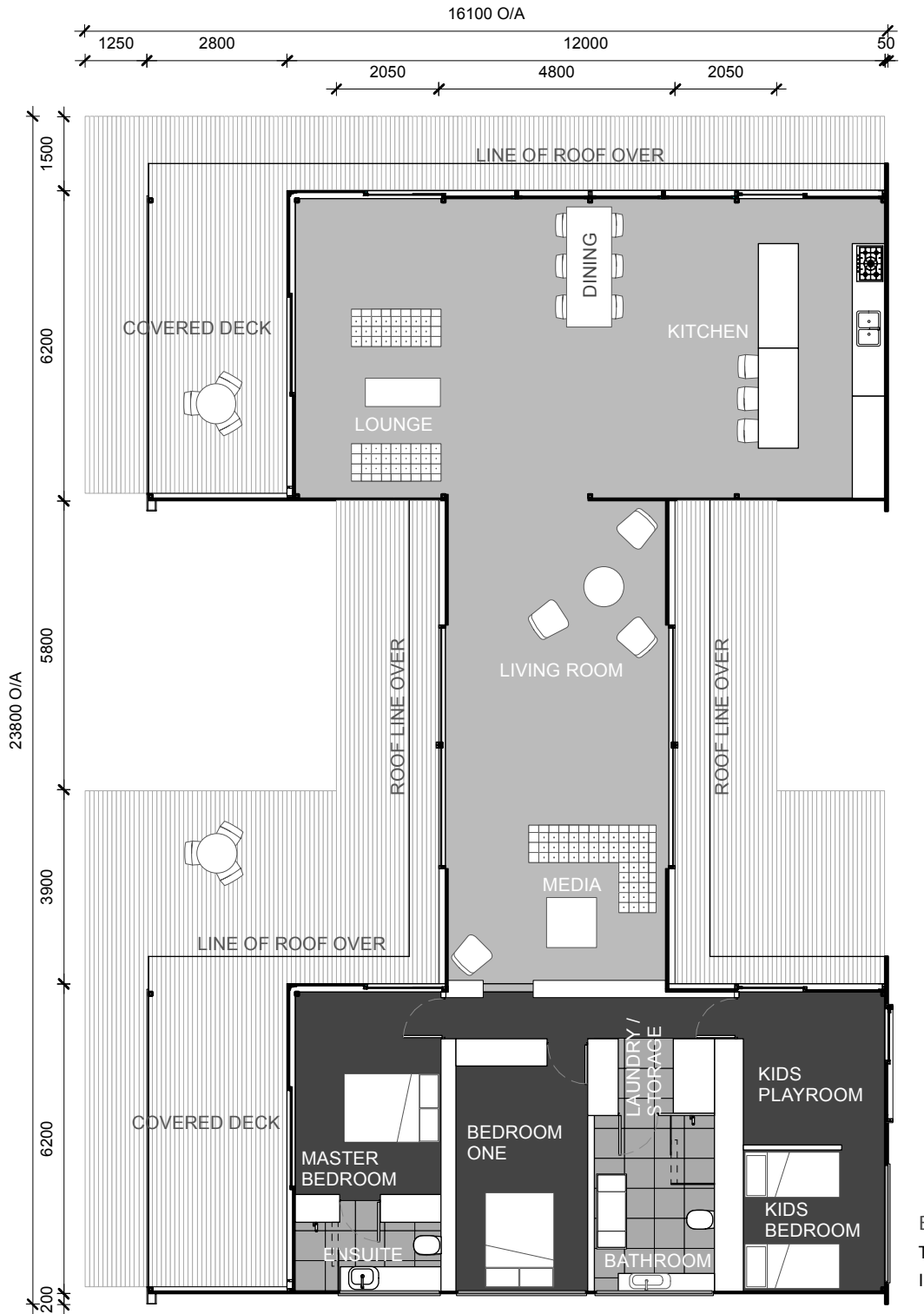

Building Area
 Total Site coverage - 338 sqm
 Interior floor area - 194 sqm



MODULE H
 not to scale

0m 1m 5m

module creative

Module Creative Limited
 1020 Ferry Road Ferrymead P.O Box 17597 Christchurch Phone +64 3 384 9474 Fax +64 3 384 8317
 Email info@quickliving.co.nz Web www.quickliving.co.nz

THIS DRAWING AND ALL ASSOCIATED SPECIFICATIONS / INSTRUCTIONS REMAIN INTELLECTUAL PROPERTY OF MODULE CREATIVE LIMITED