

QUICK LIVING

MODULAR HOUSING

Imagine building your home in 30 days... we can

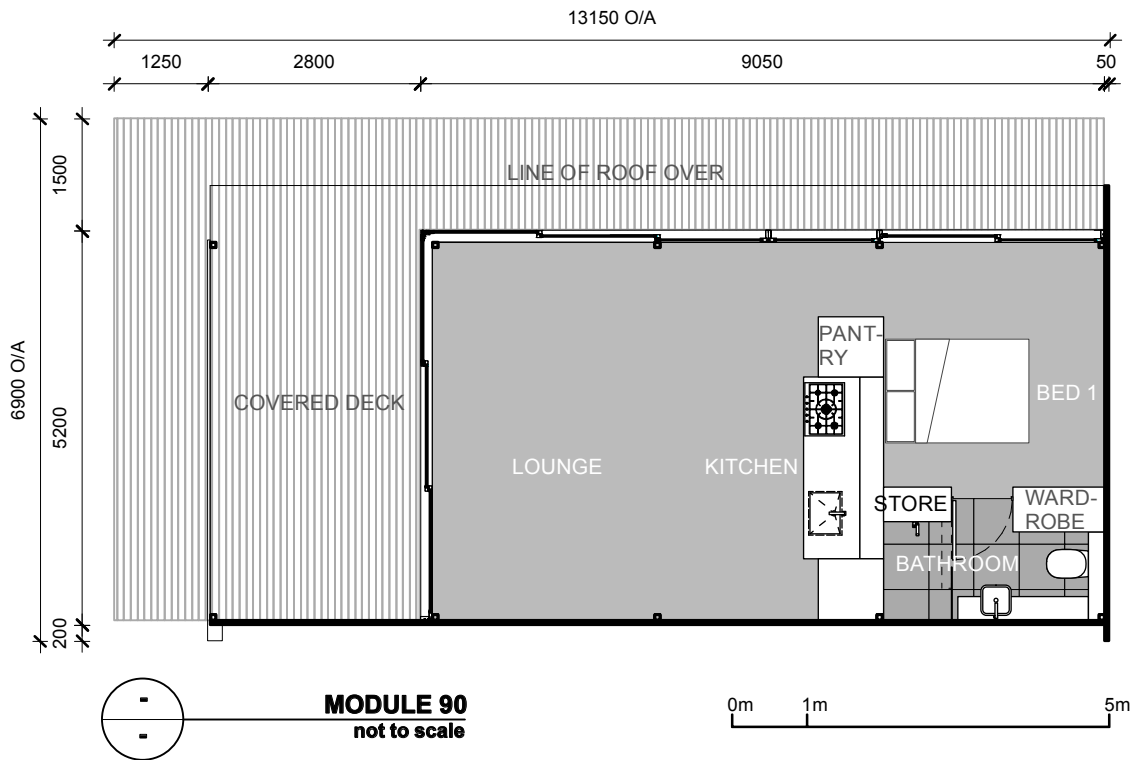

Building Area

Total Site coverage - 88sqm

Interior floor area - 45 sqm

module creative

Module Creative Limited

1020 Ferry Road Ferrymead P.O Box 17597 Christchurch Phone +64 3 384 9474 Fax +64 3 384 8317
Email info@quickliving.co.nz Web www.quickliving.co.nz

THIS DRAWING AND ALL ASSOCIATED SPECIFICATIONS / INSTRUCTIONS REMAIN INTELLECTUAL PROPERTY OF MODULE CREATIVE LIMITED

THIS DRAWING AND ALL ASSOCIATED SPECIFICATIONS / INSTRUCTIONS REMAIN INTELLECTUAL PROPERTY OF MODULE CREATIVE LIMITED