

QUICK LIVING

MODULAR HOUSING

Imagine building your home in 30 days... we can

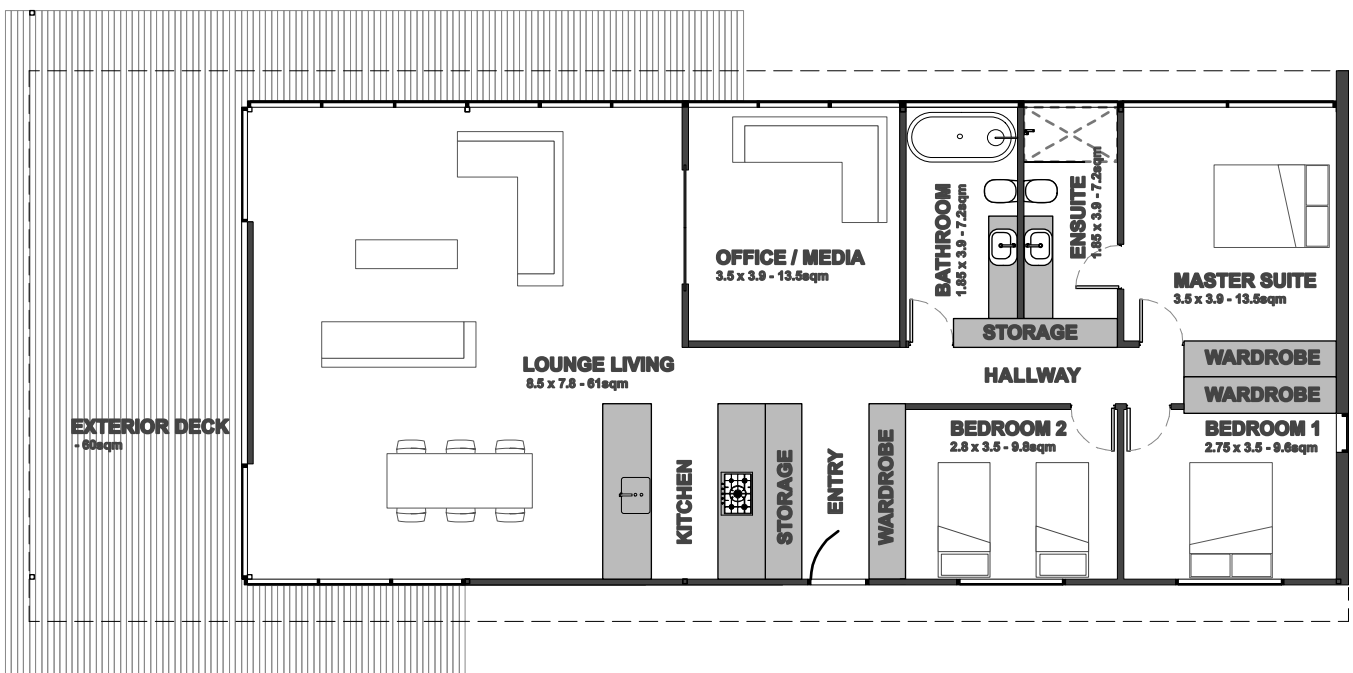

MODULE 200
N.T.S

Building Area

Total Site coverage - 200sqm

Interior floor area - 140 sqm

module creative

Module Creative Limited

1020 Ferry Road Ferrymead P.O Box 17597 Christchurch Phone +64 3 384 9474 Fax +64 3 384 8317
Email info@quickliving.co.nz Web www.quickliving.co.nz

THIS DRAWING AND ALL ASSOCIATED SPECIFICATIONS / INSTRUCTIONS REMAIN INTELLECTUAL PROPERTY OF MODULE CREATIVE LIMITED