

# QUICK LIVING

## MODULAR HOUSING

Imagine building your home in 30 days... we can

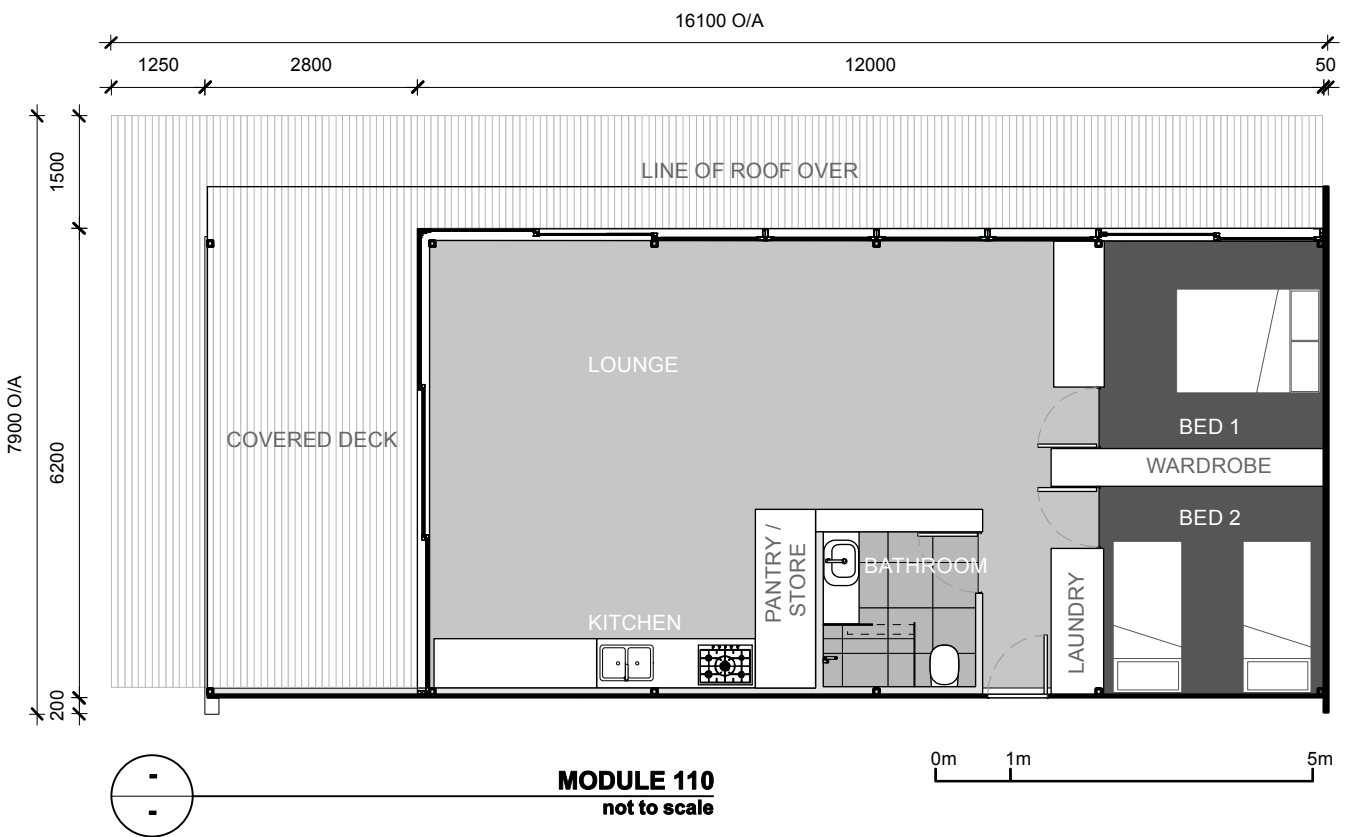

Building Area  
Total Site coverage - 120 sqm  
Interior floor area - 74 sqm

**module creative**

Module Creative Limited  
1020 Ferry Road Ferrymead P.O Box 17597 Christchurch Phone +64 3 384 9474 Fax +64 3 384 8317  
Email info@quickliving.co.nz Web www.quickliving.co.nz

THIS DRAWING AND ALL ASSOCIATED SPECIFICATIONS / INSTRUCTIONS REMAIN INTELLECTUAL PROPERTY OF MODULE CREATIVE LIMITED